

## **H OPERATION TEST**

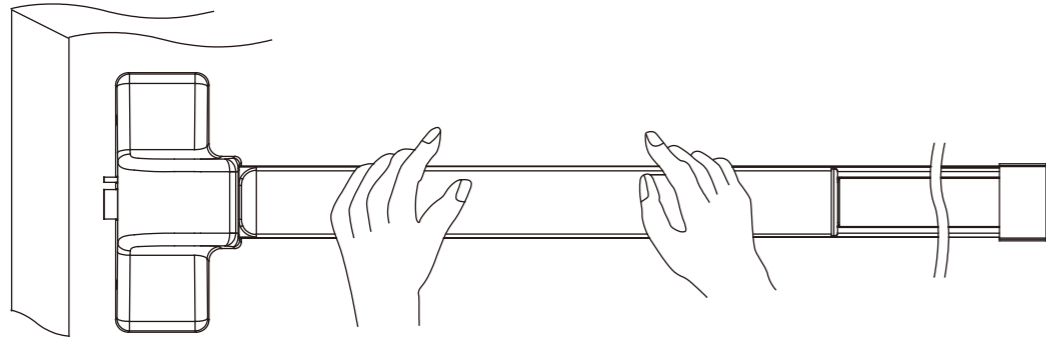

PRESS DOWN THE ACTUATING BAR. TRY TO OPEN AND CLOSE DOOR AFTER INSTALLATION COMPLETED

### **NOTICE:**

TO EXTEND THE LIFE OF THIS PANIC DEVICE, LOCK THE LATCH IN THE RETRACTED POSITION WHEN DOOR IS IN CONTINUOUS USE.

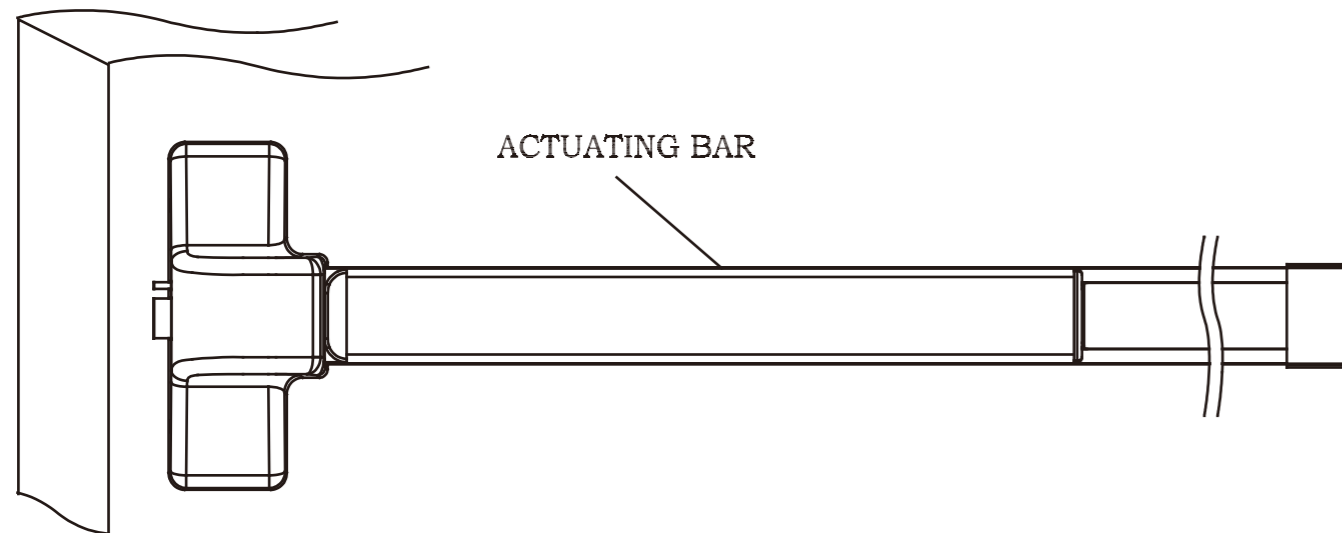

### **TO LOCK**

HOLD ACTUATING BAR DOWN. TURN DOGGING DEVICE COUNTER CLOCKWISE WITH DOGGING WRENCH.

### **TO UNLOCK**

HOLD ACTUATING BAR DOWN. TURN DOGGING DEVICE COUNTER CLOCKWISE WITH DOGGING WRENCH.

# **T341H06**

## **FIRE RATED EXIT DEVICE**

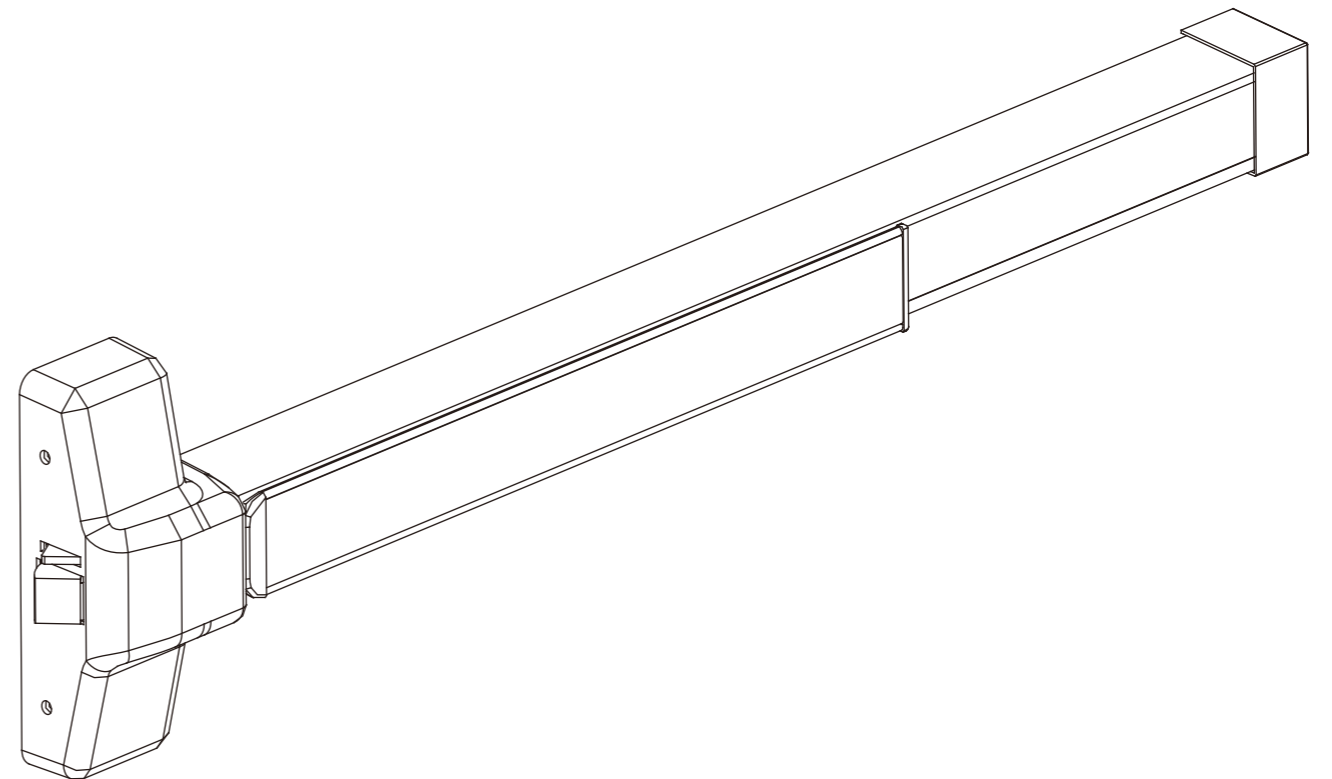

## **INSTALLATION INSTRUCTIONS**

## A IDENTIFICATION OF PARTS

IF DOOR IS LESS THAN 36",  
TAKE OFF END COVER AND  
CUT SECTION "A"  
TO REACH DESIRED  
TOTAL LENGTH

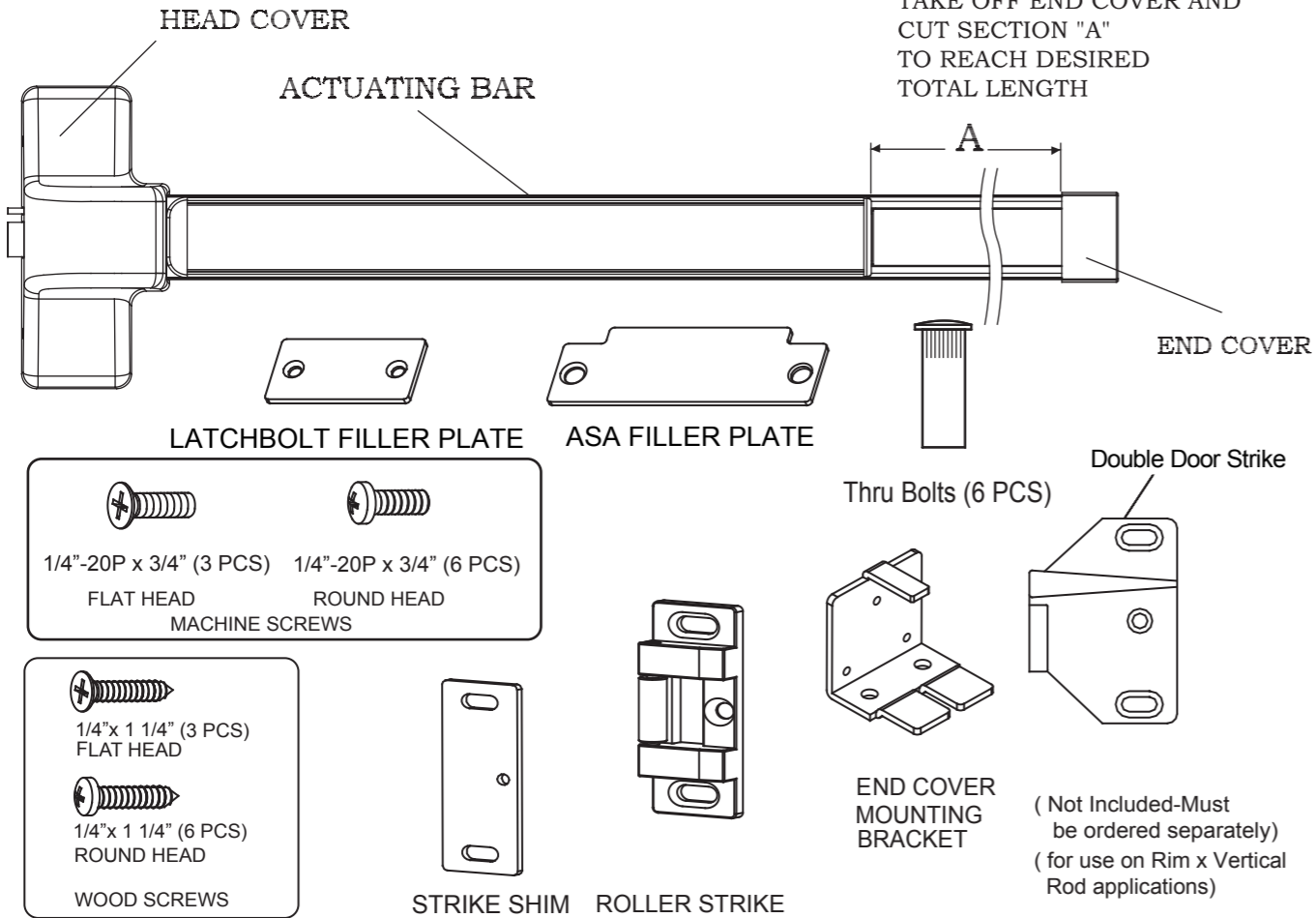

## B TYPE OF INSTALLATION

### A. SINGLE DOOR

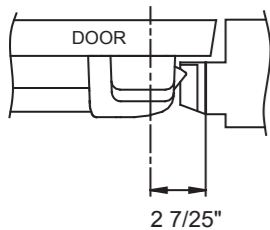

### B. DOUBLE DOOR WITH MULLION

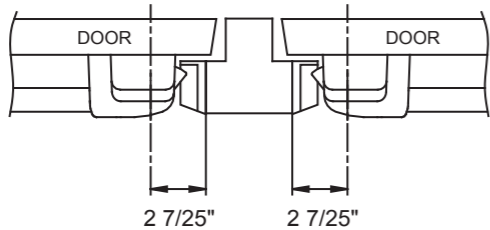

### C. DOUBLE DOOR WITHOUT MULLION

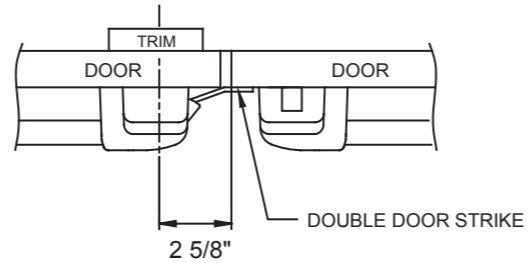

## C DRILL HOLES

Drill 9/32" holes inside and 3/8" holes outside for the (6) thru bolts and drill & tap for (3) 1/4"x20 machine screws for the Roller Strike.

1. USE TEMPLATE ENCLOSED TO MARK DOOR FACE AND DRILL HOLES IN ACCORDANCE WITH THE DIAMETERS SUGGESTED

2. "B" LENGTH SHOULD BE MEASURED FROM THE CENTER OF CYLINDER HOLE TO THE END OF THE BODY

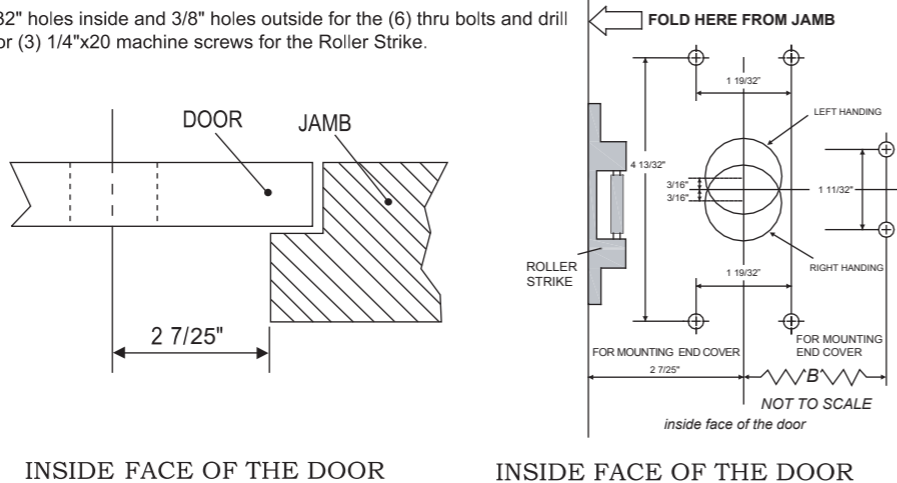

## D INSTALL KEY CYLINDER

If required or skip to step E

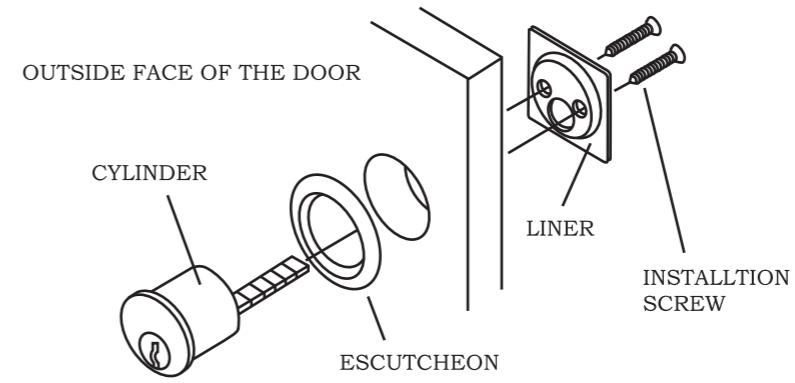

1. INSERT THE CYLINDER INTO THE HOLE ON THE DOOR
2. KEEP THE TAILPIECE HORIZONTAL
3. TIGHTEN THE SCREWS

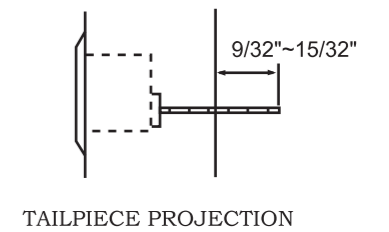

## E INSTALL BODY

1. REMOVE THE HEAD COVER AND END COVER.
2. ALIGN THE SCREW HOLES ON THE BODY WITH THE HOLES ON THE DOOR.
3. INSERT SCREW BOLT (6PCS) 3/8" FROM OUTSIDE OF THE DOOR THEN TIGHTEN THE 1/4" ROUND HEAD SCREW (6PCS) FROM INSIDE OF THE DOOR ON THE BODY AND THE MOUNTING PLATE OF END COVER.

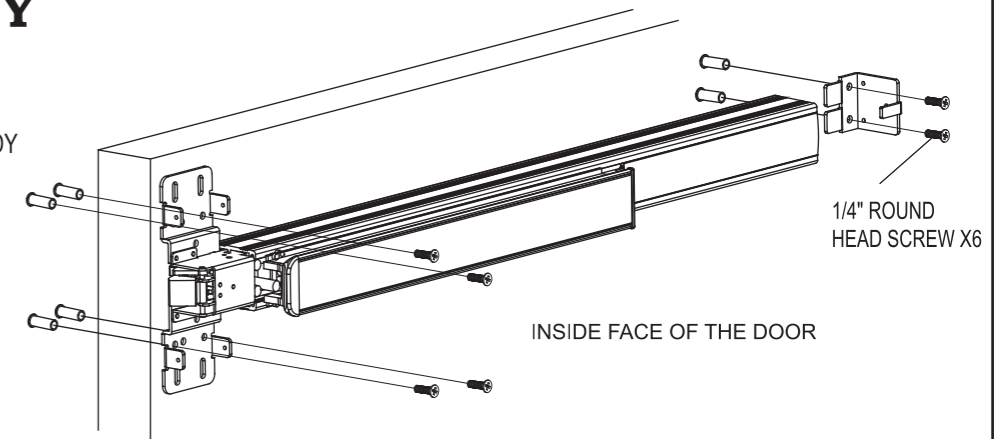

## F PUT ON BOTH HEAD AND END COVER

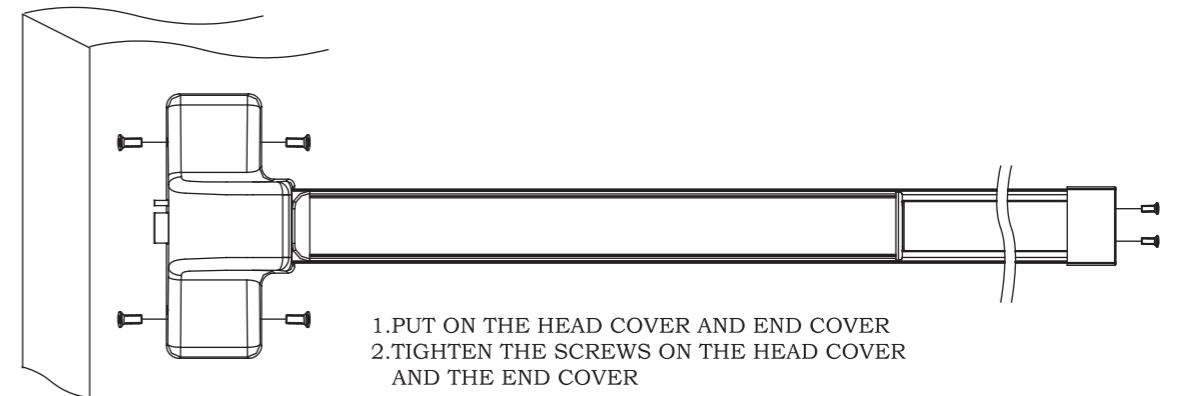

## G INSTALL ROLLER STRIKE

1. CLOSE DOOR AND MARK LATCHBOLT ON DOOR JAMB WITH A PENCIL.
2. PLACE ROLLER STRIKE ON DOOR JAMB. ALIGN CENTER OF ROLLER STRIKE WITH CENTER OF PENCIL MARK. THEN ALIGN OUTSIDE EDGE OF ROLLER STRIKE WITH OUTSIDE EDGE OF DOOR JAMB.

3. MARK IN THE CENTER OF 2 ADJUSTABLE SLOT AND DRILL 7/32" PILOT HOLE AND 1/4"-20P THREAD AT MARKED LOCATION THEN TIGHTEN WITH 1/4"-20P FLAT HEAD SCREWS. OPEN AND CLOSE DOOR TO CHECK IF LATCHBOLT CAN EXTEND AND RETRACT PROPERLY. ADJUST ROLLER STRIKE IF NECESSARY.
4. WITH THE ROLLER STRIKE IN FINAL POSITION, DRILL AT THE CENTER 7/32" PILOT HOLE AND 1/4"-20P THREAD AND TIGHTEN WITH 1/4"-20P FLAT HEAD

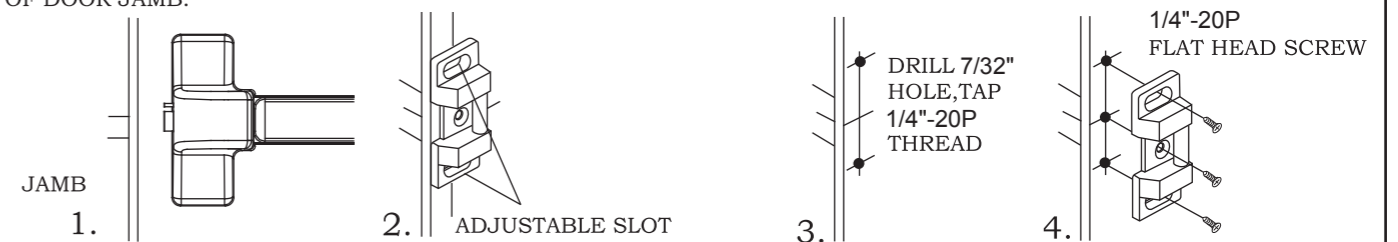

# TEMPLATE FOR INSTALLING PANIC EXIT DEVICE

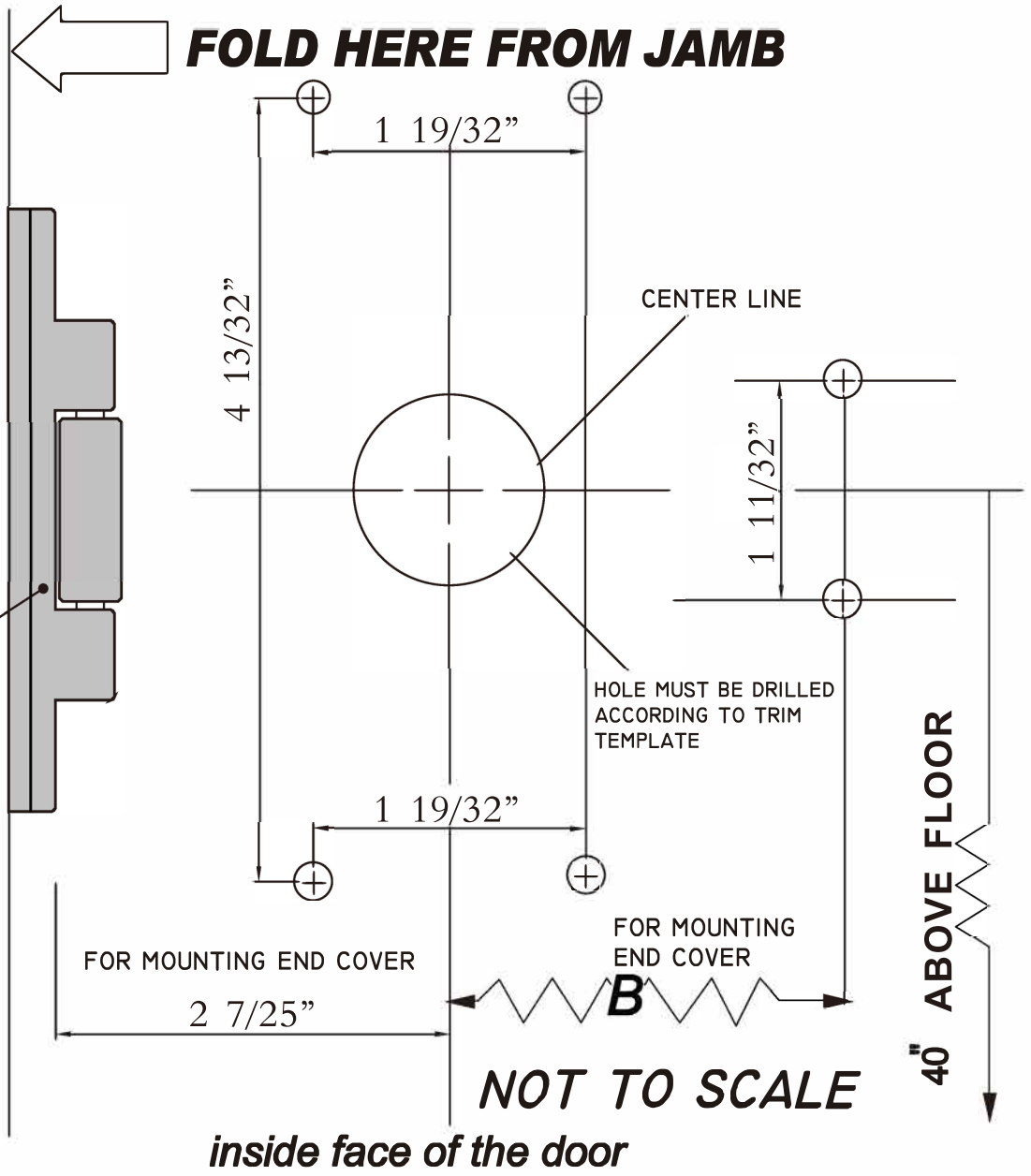
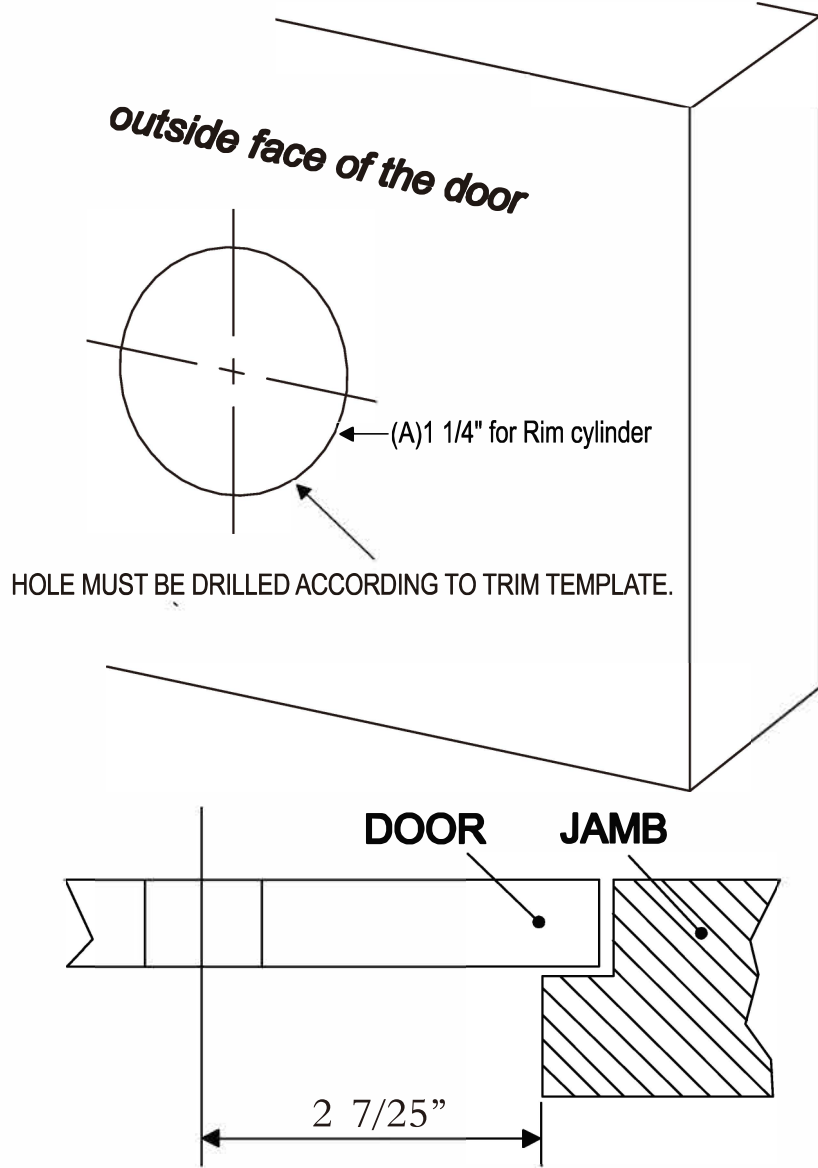

(A) For T341H07 Series (UL Listed)-Drill & tap for (6) 1/4" x 20 machine screws for Exit Device and Drill & tap for (3) 1/4" x 20 machine screws for Roller Strike.  
OPTIONAL for T341H07 (UL Listed)

(B) For T341H06 (Fire Rated)-Drill 9/32" holes inside and 3/8" holes outside for the (6) thru bolts and Drill & tap for (3) 1/4" x 20 machine screws for Roller Strike.