

T341H SERIES

Grade 1 panic device



Specifications

Type: Push bar, Rim Type, UL listed. ANSI/BHMA Grade 1 Panic Exit Device, confirm to UL 10C3 hours fire test.

ANSI/BHMA Grade 1 Panic Exit Device, confirm to UL 10C 3 hours fire test

: SS304 Stainless Steel Body & push pad

Length: 840mm (33") Standard, could be customized.

Non-handed, for LH or RH doors.

Device can be cut to 27"

Size of the head 8" H (203mm) x 3" W (75mm)

Master Key System are available.

CERTIFICATIONS:

- ANSI/BHMA Grade 1
- UL/cUL Listed for up to 3 hours
- UL10C Positive Pressure Rated
- UL10B Neutral Pressure Rated(This clause should be for the door)
- 5 Years Warranty

A IDENTIFICATION OF PARTS

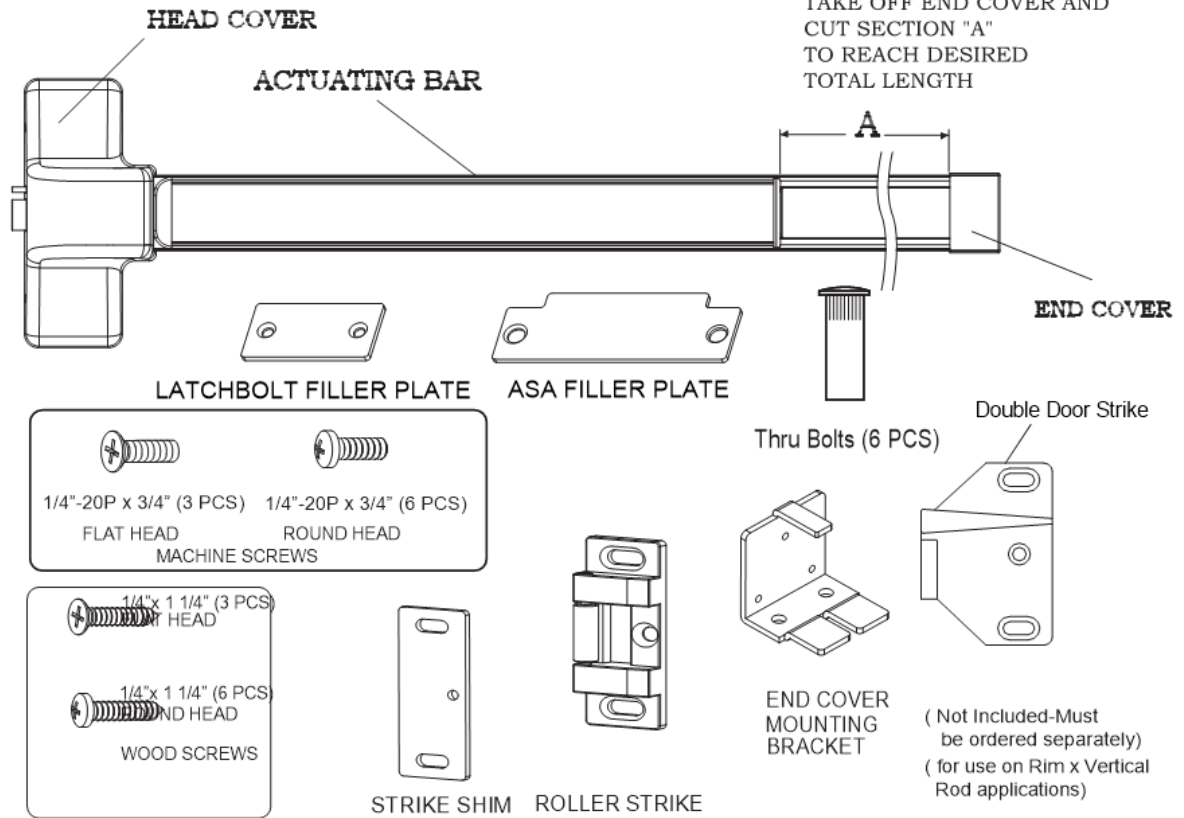

2 OPTIONAL PARTS

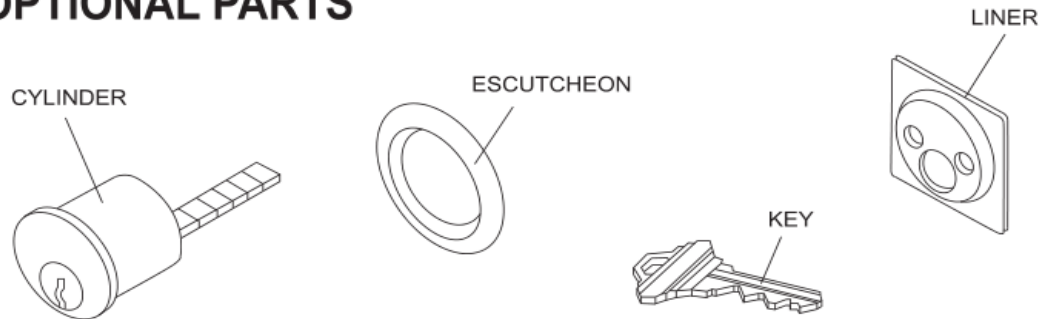

DIMENSIONS

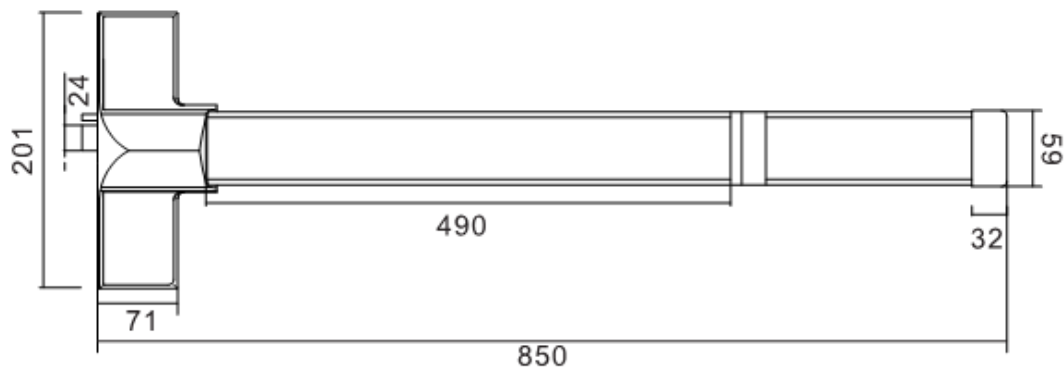

TECHNICAL INFORMATION & FUNCTION

Width of push bar (mm) Max.	840mm Standard, could be customized	
Material	Stainless Steel US32D	
Hand Operation	Field Reversible	
UL Listed	Yes	
UL 3 Hours Fire Rated	Yes	
Finish	Stainless Steel.	
ANSI/BHMA A156.3 -2008 Grade 1	Yes	
Applicability	Can be used for left and right-hand doors	
Accessories:	Fixing screws, end cover, striker	
Usage Locations	Flush Stile Aluminum Doors & Flush Commercial Doors for Heavy Duty Usage	
Dimension of Main Body (mm)	Length	840 mm (33")
	Width	205 mm (8")
	Height	63 (2")
Weight (kg)	4.5 kg (10lbs)	
Passed Durability Test	500,000 cycles	

Code	Material	Packing	Carton size
T341H	SS304	4 sets/ctn	95.5*27*49 cm (38"*11"*20")

Installation methods

B TYPE OF INSTALLATION

A. SINGLE DOOR

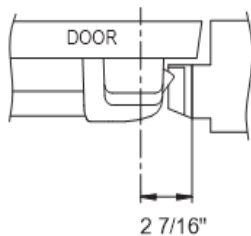

B. DOUBLE DOOR WITH MULLION

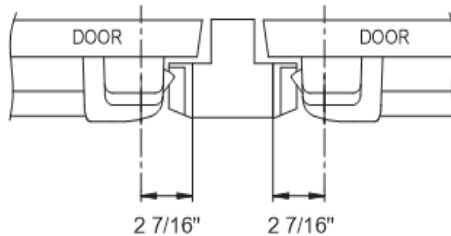

C. DOUBLE DOOR WITHOUT MULLION

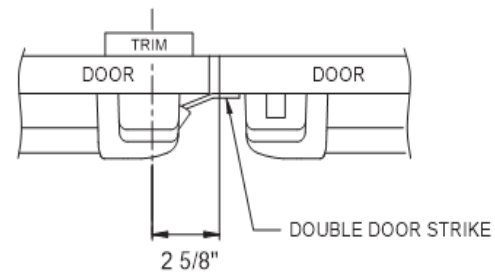

Unit adjustment

H OPERATION TEST

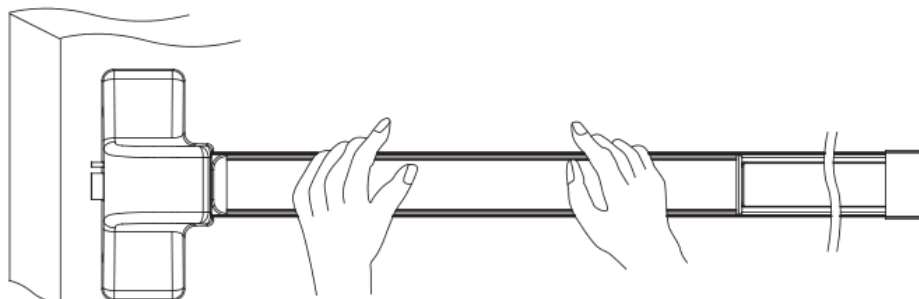

PRESS DOWN THE ACTUATING BAR. TRY TO OPEN AND CLOSE DOOR AFTER INSTALLATION COMPLETED